

Drawing name:

Version: A/0

Front view

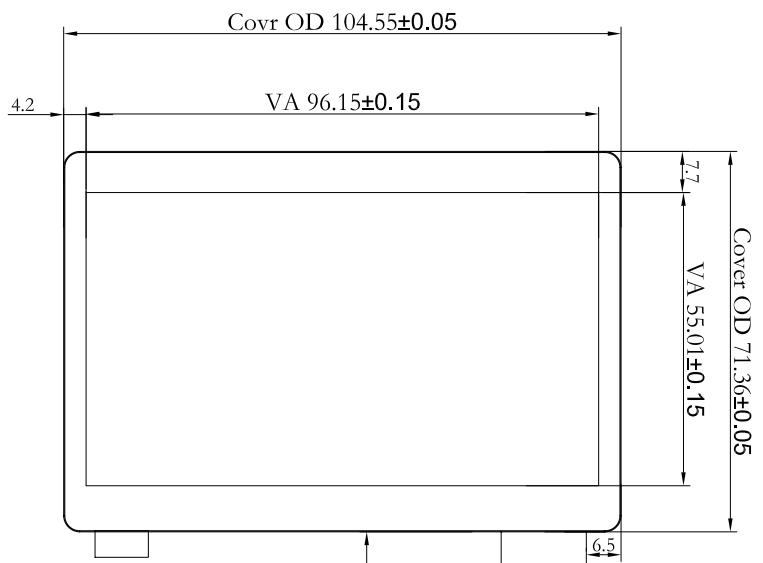

Side view

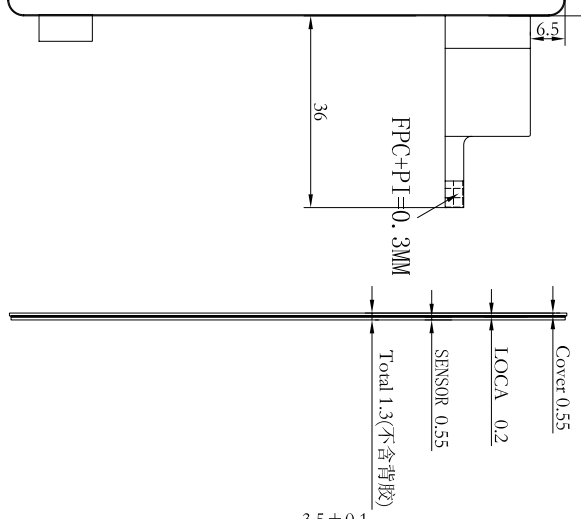

Back view

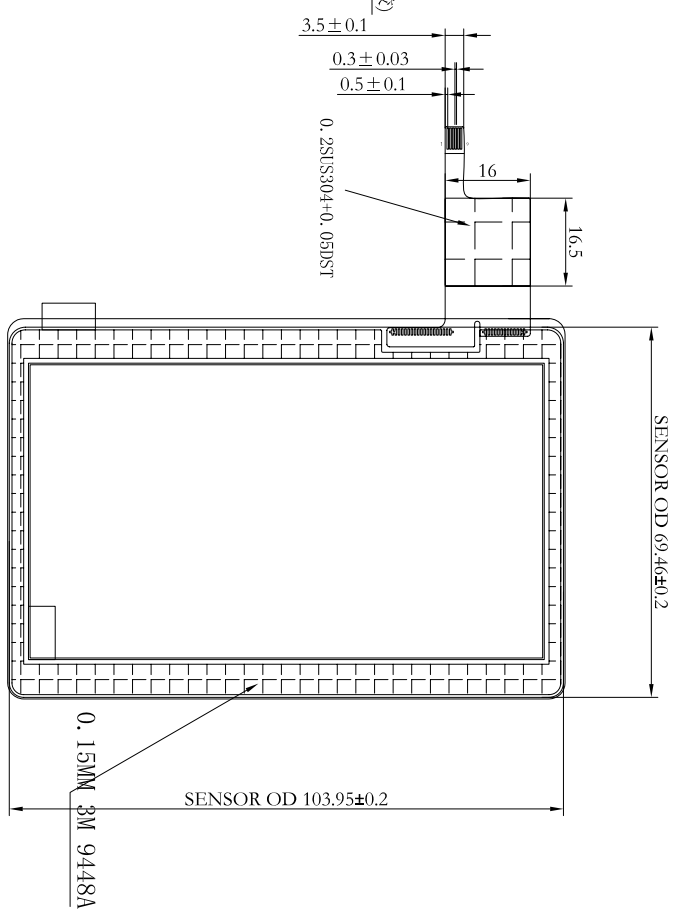

Technical parameters:

- 1. IC: ICN8110
- Cover GLASS: 0.55mm
- OCA: 0.2mm
- ITO SENSOR: 0.55mm
- Lead line: FPC (PINCH=0.5mm)
- Total thickness: 1.3±0.15mm
- 2. Working voltage: 2.8V-3.3
- 3. Light transmittance: ≥82%
- 4. Surface hardness: 6H
- 5. Operating temperature: -20°C~+70°C, ≤90%RH
- 6. Storage temperature: -30°C~+80°C, ≤90%RH

Instructions:

- 1. Structure type: Glass+Glass.
- 2. Unmarked tolerance : ±0.20;
- 3. Comply with ROHS standards;

TP PIN SYMBOL

SYMBOL	PIN
1	RST
2	INT
3	GND
4	SDA
5	SCL
6	VDD

TYPE	Describe	Date
V00	New design	2018/11/20

Unmarked tolerance	3RD ANGLE PROJ
0.005-0.040 ±0.1	3RD ANGLE PROJ
>0.040 ±0.20	3RD ANGLE PROJ
>1.0 ±0.5	3RD ANGLE PROJ

Contract ID	Document number	Date	Proposition
WTY043734A01	WTY043734A01	2018/11/20	1:1

深圳市万天源光电有限公司
 Shenzhen Wanty Photoelectric Co., Ltd